

Evolution, accuracy and reliability in the operating room



With its constant attention to the evolution of technology and clinical needs and aware of the responsibility of operating in a sector of such importance as the medical one, ACEM Medical Company (Division of ACEM SpA) is considered a partner for surgeons and medical staff in the OR. STARLED5 NX, surgical lamp with LED technology, is born to meet the needs of its user granting optimal performances, reliability and visual comfort.

COLD LIGHT FOR YEARS

LED technology for exclusive performances



STARLED5 NX boasts an excellent light quality. The special optics of its LEDs, realized by ACEM, generates a shadowless, clear and homogeneous light assuring visual comfort and best working conditions both for the surgeon and for the medical staff.

Thanks to its next generation LEDs, the lamp can produce a perfect illumination under every condition generating a IR-free light, an excellent colour temperature and a practically endless life cycle at low consumptions.



The 43 LEDs which make the STARLED5 NX are circularly positioned and divided into 5 reflectors (with 7 LEDs each one) and other 8 LEDs are radially placed around the handle. The lamp produces in this way a high illumination level of 130.000 lux (160.000 lux optional) for a steady life cycle of about 50.000 hours.

ACRIS is the extraordinary and innovative system realized by ACEM that ensures, by the use of a microprocessor, the control of electrical curves typical of LEDs to remain unaltered over the time but maintaining a long life cycle. The colour rendering index of STARLED5 NX is 95 and its colour temperature 4.500°K. These two values allow to reproduce the exact chromatic scale of the colours of the human body.



STARLED3 NX is a lamp manufactured by ACEM based on the last generation LED technology, assuring cold light, long life and low energy consumption. The lamp is suitable for countless applications both for surgery and operating room. It is ideal for diagnosis, dental sector, gynaecology, dermatology, general medicine and surgery.



STARLED3 NX grants a homogeneous and shadowless light thanks to its special LED optics created by ACEM Medical Company that directs light beams at best according to the needs.

The visual area is perfectly illuminated assuring both excellent visual comfort and working conditions.

Its next generation LEDs produce an unparalleled quality of light with a colour temperature (CCT) of 4.500 °K and a colour rendering index (CRI) of 95.

STARLED3 NX has a light intensity of 130.000 lux with a low energy consumption of 69W.

The life cycle of its LEDs is about 50.000 hours.



I-SENSE® CONTROL PANEL
FOR FUNCTIONS ADJUSTMENT

EASY MOVEMENT THANKS
TO THE LATERAL HANDLES

SUITABLE DESIGN FOR
LAMINAR FLOWS

COLD AND
SHADOWLESS LIGHT

REMOVABLE AND
STERILIZABLE HANDLE

NEW GENERATION LEDs
FOR EXCELLENT PERFORMANCES

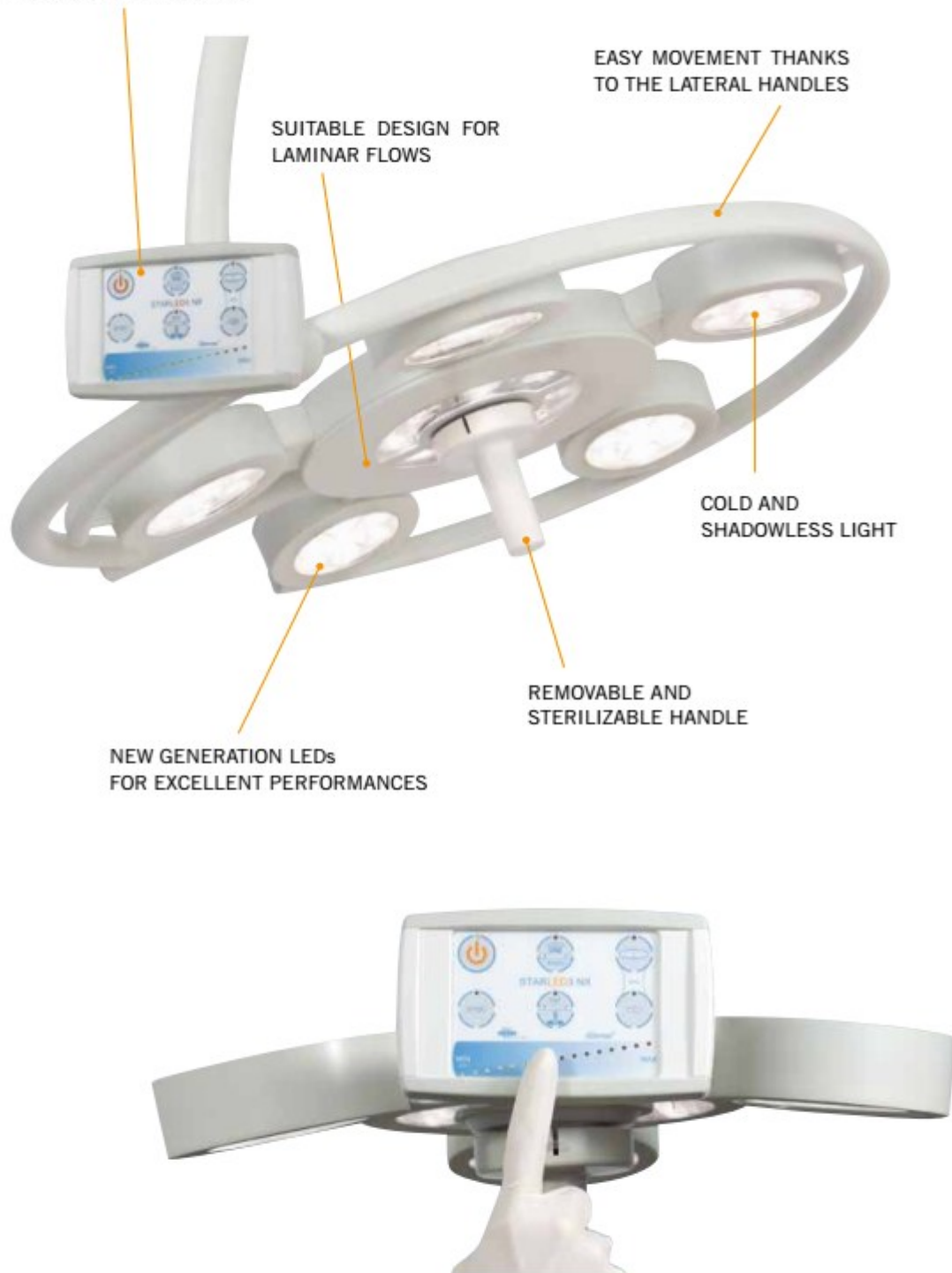

Functions are adjusted by its innovative easy-to-read, ergonomic and easy-to-clean I-SENSE® control panel.

With a simple touch it can manage easily and accurately:

- ON/OFF function
- Light intensity adjustment
- DoF - Depth of field - for a deep light
- ENDO - Light for endoscopy ideal for minimal-invasive surgery
- SIZE - Light spot diameter adjustment to focus the operating area
- SYNC - Function (optional) useful to synchronize controls of the combined lamps: STARLED3 NX double (twin dome configuration) and STARLED3 NX together with STARLED5 NX or STARLED7 NX.

STARLED5 NX + STARLED 3 NX

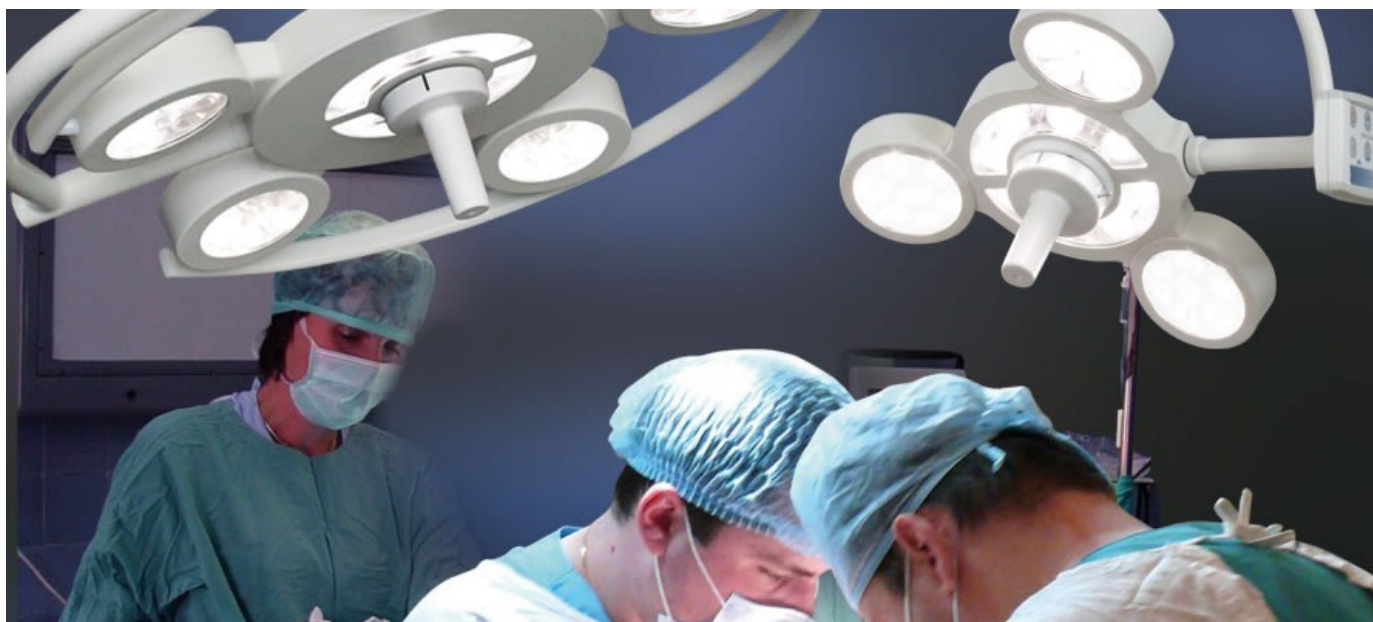

TECHNICAL FEATURES	STARLED5 NX	STARLED3 NX
Product Class (EN 60601-2-41)	I	I
Power supply	100-240 VAC $\pm 10\%$	100 - 240 VAC $\pm 10\%$
Power consumption	75W (90 W @ 160K lux)	69 W
Frequency	50/60 Hz	50/60 Hz
Light source	LEDs	LEDs
Average life	50.000 hrs about	50.000 hrs about
Lighting at the centre, Ec @ 100 cm	160.000 lux	130.000 lux
Intensity adjustment from	5% to 100%	5 % to 100%
Colour temperature,	4.500 °K	4.500 °K
Colour rendering index,	Ra 95	Ra 95
Light feld size	24 - 33 cm	24 - 33 cm
Focusable working distance	70 - 150 cm	70 - 150 cm
Lighting depth L1+L2	64 cm	71 cm
Dimensions, weights and further data		
Light head weight	12 Kg	4 Kg
Light head diameter	67 cm	50 cm
Handle Removable and sterilizable		
Colour White rAL 9002		



ACEM SpA
Medical Company Division
Via della Tecnica 29 - 40050 Argelato
Bologna - ITALY
Ph +39 051 721844 Fax +39 051 721855
info@acem.it www.acem.it



Acem Medical Company is a registered trademark of Acem S.p.A. All rights reserved
ACEM reserves the right to modify the design and specifications
contained herein without any prior notice.

Dep.STARLED3NX.OPT.EN rev.2016-01